

## Lot Charges

	Resident	Non-Resident
Blocks 119-122, 128, 160-194 .....	\$650	\$780
Blocks 138-141, 150-151, 200 .....	\$1,100	\$1,320
Blocks 202-204, 208-209 .....	\$1,300	\$1,560
Blocks 210-212 .....	\$1,600	\$1,900
Blocks 152, 207 .....	\$1,800	\$2,160
Block 213 .....	\$2,250	\$2,700
Block 153 .....	\$2,300	\$2,760
Block 154 .....	\$3,450	\$4,140
Baby section .....	\$100	\$120

Price is per grave space and includes perpetual care. See map, page 3.

## Columbariums

	Resident	Non-Resident
Blocks 33, 66, 118, 206 .....	\$1,200	\$1,440
Block 190 .....	\$600	\$720
Honor Garden (veterans/spouses only) .....	\$500	\$600

## Scattering Garden Inscriptions

Inscription, 2 lines .....	\$375
Additional line .....	\$160
Final date cut .....	\$180

## Columbarium Memorial Wall Inscriptions

Inscription, 1 line .....	\$240
Additional line .....	\$120
Final date cut .....	\$140

## Pre-Paid Charges

Greenwood allows prepayments on the following charges:

Grave opening, Casket .....	\$700
Grave opening, Cremation (in-ground or niche) .....	\$350
Final Date Cut on Marker (not raised letters) .....	\$220

Pre-paid grave opening charges are for weekday, non-holiday interments made between 10 a.m. and 3:30 p.m. The cemetery will not accept pre-paid charges for Saturday or holiday grave openings.

## Foundation Charges

20x10 .....	\$84	36x12 .....	\$181	54x16 .....	\$362
24x12 .....	\$120	42x14 .....	\$246	60x16 .....	\$403
30x12 .....	\$150	48x14 .....	\$282	66x18 .....	\$498

Contact the office for larger sizes. Anyone wishing to install foundations in the cemetery must pay a location fee (\$100 for 48" or shorter, \$250 for 49" or longer) for cemetery personnel to locate the correct placement for the foundation. Form and payment must be submitted prior to installation. Greenwood Cemetery does not require a border around the marker.

Price list as of Jan. 8, 2025

## Interment (Burial) Charges

No Sunday burials

### Service Hours:

- 10 am-3:30 pm for all processions from church or funeral home and graveside cremation services
- 11 am-3:30 pm for graveside casket services

### Adult (37-inch vault and above)

Monday-Friday .....	\$700
Saturday .....	\$1,000
Holiday* .....	\$1,200

### Cremations (cremation burial vault required)

Monday-Friday .....	\$350
Saturday .....	\$600
Holiday* .....	\$700

## Winter Processions

Above all other charges .....

Not applicable if mourners are not present

## Directional Signs

By request, the cemetery may provide directional signs for scheduled funerals. If you are doing your own service or scattering on a Saturday or holiday, we will place signs for a fee of \$250.

## Late Charges

Add \$75 per half hour for procession entering the cemetery after 3:30 p.m. or for services starting at 3:30 p.m. or later

## Grave Setup Charges

Tent .....	\$200
Chairs (8) .....	\$50
Chairs (12) .....	\$100

Cremation or memorial services only.  
Not in lieu of vault company tent

### Infant (Up to 36-inch Vault)

Monday-Friday .....	\$100
Saturday or holiday .....	\$250

### Disinterment (Normal re-interment charges will apply)

Adult .....	\$850
Infant .....	\$230
Cremation .....	\$350

**Payments** are due two (2) full business days prior to scheduled interment. A 3.5% administration fee will be applied if paying by debit or credit card(s).

### \*Holidays

New Year's Day, Memorial Day, Independence Day, Labor Day, Thanksgiving, Friday after Thanksgiving, Christmas Eve, Christmas Day

## Burial Vaults Full Size and Cremations

Cemetery regulations require the use of an approved burial vault for all interments including cremations. Some examples of approved cremation vaults are Crowne Regent, Batesville Pebblecove, or Wilbert Universal Urn/Vault. Call us at 231-347-6531 if you wish to use some other vault. The top of the cremation vault must be 100 square inches or larger.

## Burial Authorization Form

Cemetery regulations require a signed Burial Authorization Form before opening a grave.

- This form must be signed by the lot owner, an heir of the lot owner, or someone designated in writing by one of the above with the authority to give authorization for burial.
- When it is impossible for a visit to the Cemetery Office, authorization must be given by mail, email, or fax within the designated time. (Authorization by phone is not acceptable)
- The Burial Authorization Form must be signed and in our possession a minimum of two (2) working days prior to the scheduled burial.
- Payment in full must be received two (2) working days prior to the scheduled burial. This may be paid by credit card, cash or check or may be guaranteed by the attending Funeral Director and delivered prior to the interment.
- The "On-Time Deposit," if applicable, must be paid two (2) working days prior to the scheduled burial. It will be returned if the mourners assemble for the ceremony within 10 minutes of the scheduled time.

## Winter Burials

Burials will be made throughout the winter except on Sundays or when weather conditions make the interment process unsafe. Burials are made in the winter at the discretion of the Superintendent. A procession during the winter will be \$350 above the normal charges. A "procession" includes one or more persons other than funeral home personnel.

## Baby Section

Only flush markers are allowed. Greenwood Cemetery will supply one temporary grave marker which remains the property of the cemetery. Family may plant flowers only, no shrubbery.



## History Books

Most years, Greenwood Cemetery offers various tours of the grounds and rich history of the people of Petoskey who have come before us and have helped to make it what it is today.

These stories are written and designed in a thermal-bound book. You may get a copy at our office as they are available. Follow us on social media or sign up for our newsletter at [www.gwood.us](http://www.gwood.us) to stay in the loop on future tours and other events.

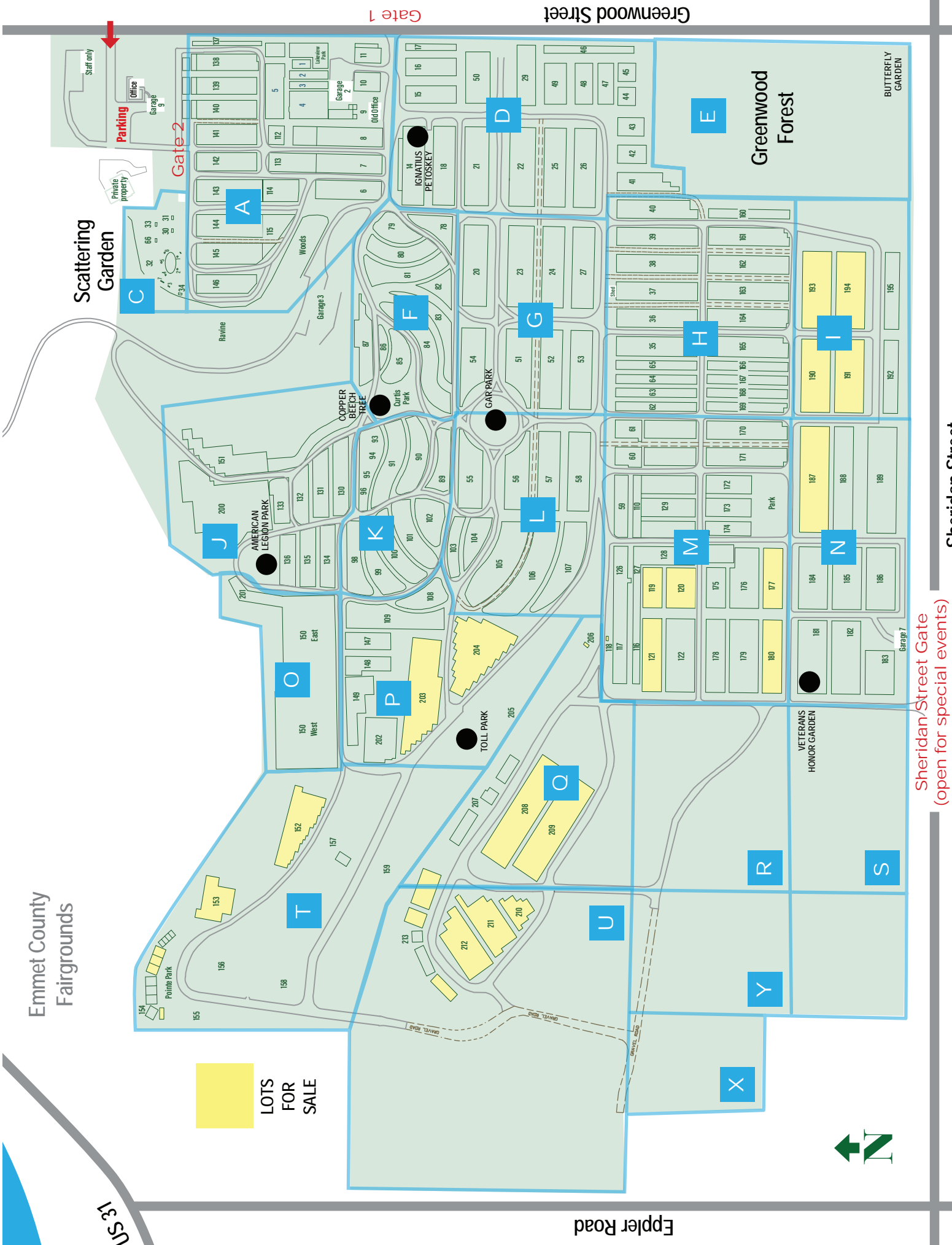

**LOTS FOR SALE**



US 31

Eppler Road

Sheridan Street Gate  
(open for special events)

Sheridan Street

Greenwood Street

Gate 1

Gate 2

Scattering Garden

Greenwood Forest

BUTTERFLY GARDEN

VETERANS HONOR GARDEN

Emmet County Fairgrounds

Staff only

Office

Private property

Garage 3

Garage 2

Garage 3

Garage 4

Garage 5

Garage 6

Garage 7

Garage 1

Garage 2

Garage 3

Garage 4

Garage 5

Garage 6

Garage 7

Garage 8

Garage 9

Garage 10

Garage 11

Garage 12

Garage 13

Garage 14

Garage 15

Garage 16

Garage 17

Garage 18

Garage 19

Garage 20

Garage 21

Garage 22

Garage 23

Garage 24

Garage 25

Garage 26

Garage 27

Garage 28

Garage 29

Garage 30

Garage 31

Garage 32

Garage 33

Garage 34

Garage 35

Garage 36

Garage 37

Garage 38

Garage 39

Garage 40

Garage 41

Garage 42

Garage 43

Garage 44

Garage 45

Garage 46

Garage 47

Garage 48

Garage 49

Garage 50

Garage 51

Garage 52

Garage 53

Garage 54

Garage 55

Garage 56

Garage 57

Garage 58

Garage 59

Garage 60

Garage 61

Garage 62

Garage 63

Garage 64

Garage 65

Garage 66

Garage 67

Garage 68

Garage 69

Garage 70

Garage 71

Garage 72

Garage 73

Garage 74

Garage 75

Garage 76

Garage 77

Garage 78

Garage 79

Garage 80

Garage 81

Garage 82

Garage 83

Garage 84

Garage 85

Garage 86

Garage 87

Garage 88

Garage 89

Garage 90

Garage 91

Garage 92

Garage 93

Garage 94

Garage 95

Garage 96

Garage 97

Garage 98

Garage 99

Garage 100

Garage 101

Garage 102

Garage 103

Garage 104

Garage 105

Garage 106

Garage 107

Garage 108

Garage 109

Garage 110

Garage 111

Garage 112

Garage 113

Garage 114

Garage 115

Garage 116

Garage 117

Garage 118

Garage 119

Garage 120

Garage 121

Garage 122

Garage 123

Garage 124

Garage 125

Garage 126

Garage 127

Garage 128

Garage 129

Garage 130

Garage 131

Garage 132

Garage 133

Garage 134

Garage 135

Garage 136

Garage 137

Garage 138

Garage 139

Garage 140

Garage 141

Garage 142

Garage 143

Garage 144

Garage 145

Garage 146

Garage 147

Garage 148

Garage 149

Garage 150

Garage 151

Garage 152

Garage 153

Garage 154

Garage 155

Garage 156

Garage 157

Garage 158

Garage 159

Garage 160

Garage 161

Garage 162

Garage 163

Garage 164

Garage 165

Garage 166

Garage 167

Garage 168

Garage 169

Garage 170

Garage 171

Garage 172

Garage 173

Garage 174

Garage 175

Garage 176

Garage 177

Garage 178

Garage 179

Garage 180

Garage 181

Garage 182

Garage 183

Garage 184

Garage 185

Garage 186

Garage 187

Garage 188

Garage 189

Garage 190

Garage 191

Garage 192

Garage 193

Garage 194

Garage 195

Garage 196

Garage 197

Garage 198

Garage 199

Garage 200

Garage 201

Garage 202

Garage 203

Garage 204

Garage 205

Garage 206

Garage 207

Garage 208

Garage 209

Garage 210

Garage 211

Garage 212

Garage 213

Garage 214

Garage 215

Garage 216

Garage 217

Garage 218

Garage 219

Garage 220

Garage 221

Garage 222

Garage 223

Garage 224

Garage 225

Garage 226

Garage 227

Garage 228

Garage 229

Garage 230

Garage 231

Garage 232

Garage 233

Garage 234

Garage 235

Garage 236

Garage 237

Garage 238

Garage 239

Garage 240

Garage 241

Garage 242

Garage 243

Garage 244

Garage 245

Garage 246

Garage 247

Garage 248

Garage 249

Garage 250

Garage 251

Garage 252

Garage 253

Garage 254

Garage 255

Garage 256

Garage 257

Garage 258

Garage 259

Garage 260

Garage 261

Garage 262

Garage 263

Garage 264

Garage 265